



OPTIMAL FOR ADVANCEDTCA, MicroTCA, ATCA 300 APPLICATIONS

Optima's AT Series of vertical rack enclosures incorporate advanced features specifically designed to address the growing complexity of blade and server applications based on the AdvancedTCA format.

In response to increased densities and higher processing speeds, Optima EPS Engineer's have developed innovative solutions to meet the challenges of today's electronic packaging needs.

CABINET FEATURES

- Advanced cooling techniques to eliminate the heat build up associated with the increasing heat density
- Engineered Cable Management solutions to efficiently control the increasing density of I/O cabling
- Ideal for today's ATCA and blade server applications
- Front and rear door
- Rugged door hinges
- 4 point latching handle system
- Removable side panels (quarter turns, slotted or keyed)
- 3 piece top cover with fan plate and cable access panels
- Door gasket for environmental sealing
- Modular base with options for: fixed mount, levelers or casters

CABLE MANAGEMENT FEATURES

- Slotted base, cable feeds with integrated management bracket
- Configurable cable brackets for vertical and horizontal cable management
- 19" vertical bracket accommodates industry standard cable brackets
- Fiber optic router for horizontal and vertical management
- 19" vertical brackets notched for up to 1" Velcro straps
- 3 x depth stiffeners for tying cables front to rear
- Top front and top rear cable access panels
- Optional 1U cable trough for mounting between sub-racks

SPECIFICATIONS

Size - 44U H x 600mm W x 600mm D (Overall Height = 2125mm)
Available Mounting - 44U (Up to 3, 14U ATCA chassis)



Wide variety of optional horizontal and vertical cable management brackets:

- D Ring
- Fiber Optic
- Velcro
- Cable trays



COOLING FEATURES

- Integrated air baffling in cabinet to ensure cooling path integrity
- Top cabinet exhaust
- 4 x 235CFM, high volume fans



Openings in top corner pieces covered with brushes for easy cable feed through, act as airflow containment baffles.



Side panel with quarter turn locks, keyed or slotted, recessed elegant appearance.



Door gasket for environmental sealing.



Base designed for under floor cable entry with integrated divider brackets to route cables to left or right side.



1,2 FRAME STYLE

AT > AT (ATCA)
ZZ > Custom

3 FRAME HEIGHT

F > 35U = (61.38" / 1559mm)
G > 40U = (70.12" / 1781mm)
H > 44U = (77.12" / 1958mm)
Z > Custom

4 FRAME WIDTH

A > 19" = (17.81" / 452.4mm)
D > 600mm
Z > Custom

5 FRAME DEPTH

A > 24" = (609.6mm)
B > 30" = (762.0mm)
E > 600mm
Z > Custom

6 MOUNTING RAIL POSITION

1 > Standard
2 > Recessed Front
3 > Recessed Rear
4 > Recessed Front & Rear
X > Not installed
Z > Custom

7 MOUNTING RAILS

5 > Telco - 40U & 44U (TIR)
6 > Reducer rail (RED)
7 > Server rail (SQ)
X > Not installed
Z > Custom

8 BASE

A > Standard (BS)
B > Standard w/casters
C > Standard w/levelers
D > Standard w/both C&L
E > Cable egress (CE)
F > Cable egress w/levelers
G > Cable egress w/casters
H > Cable egress w/both C&L
X > Not installed (XB)
Z > Custom

9 TOP PANEL

A > Solid (TS)
B > Perforated (PT)
D > Cable egress
E > Fan (TF)
X > Not installed (XT)
Z > Custom

10 BOTTOM PANEL

A > Solid
B > Perforated
C > Cable Egress
X > Not installed
Z > Custom

11 SIDE PANEL

4 > L only (lift off)
5 > R only (lift off)
6 > L & R (lift off)
X > Not installed
Z > Custom

12 FRONT DOOR

J > ACRYLIC RH
K > ACRYLIC LH
X > Not installed
Z > Custom

13 REAR DOOR

A > SOLID RH
F > SOLID LH
X > Not installed
Z > Custom

14,15 BODY / TRIM COLOR

1 > Black (207)
2 > Sky Blue (210)
3 > White (931)
4 > Deep Charcoal (209)
5 > Light Gray (201)
6 > Beige (205)
Z > CUSTOM

STEP 1: Frame Style
Height
Width
Depth

STEP 2: Mounting Rails
Frame includes 2 Pair of rails and Front-Rear Stiffeners if cabinet is over 52 inches.

STEP 3: Base
Top Panel
Bottom Panel
Side Panel

STEP 4: Doors

STEP 5: Body and Trim Color

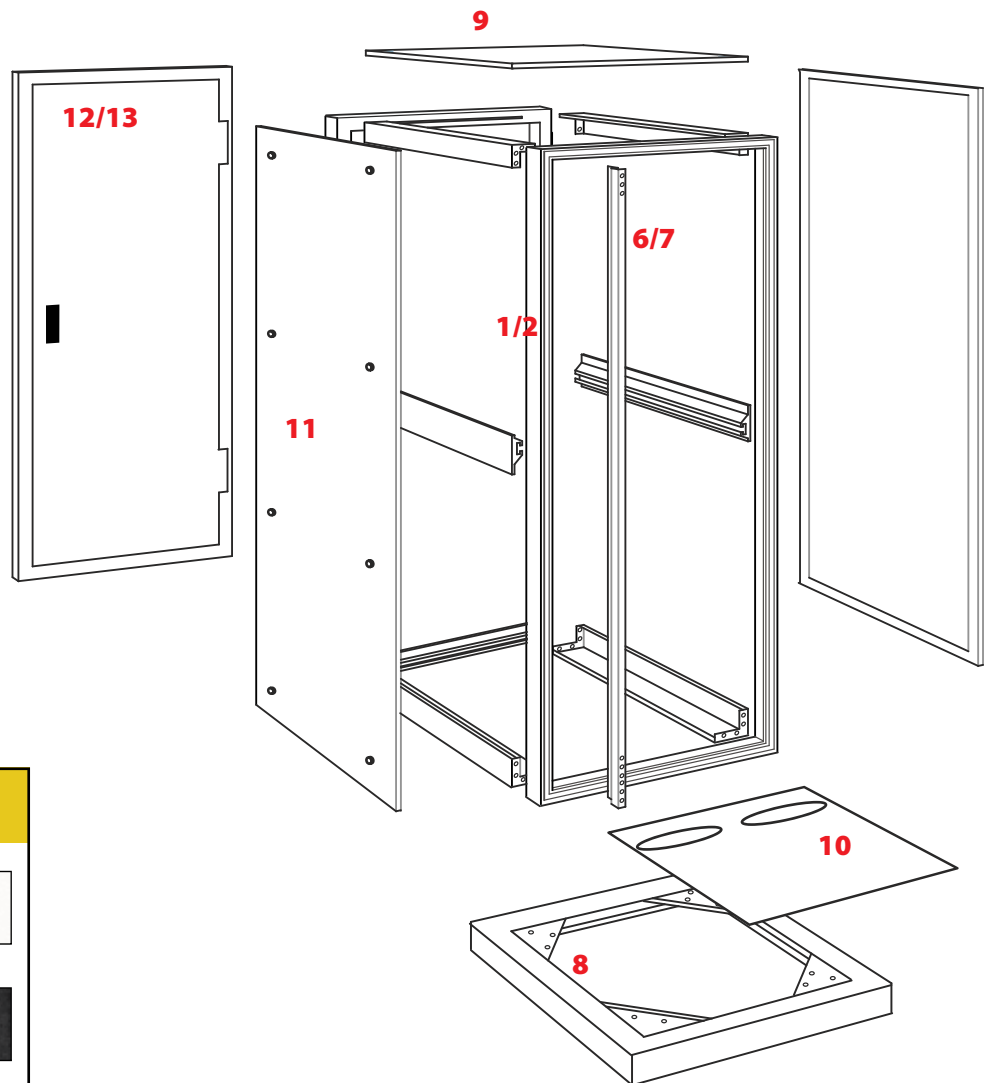

Select from 6 standard colors for cabinet, panels and trim

